

Original BMW Accessories Development of the bicycle carrier for the trailer tow hitch (E-bike) Suitable for all models

NEWS:

- New product launch

Product description

The bicycle carrier is a development of the E-bike carrier (part number 82 72 2 234 056). The bicycle carrier is even more convenient to operate, has now been equipped with removable retaining arms and can be loaded with 2 bicycles or E-bikes as standard.

Sales features / benefits

- **NEW:**
 - Removable and freely positionable retaining arms.
 - Improved quick fastening system for supporting clamp locking.
 - Even simpler to use. Folding out of the bicycle rails now in 2 instead of 4 moves.
 - Wider base frame and longer wheel moulds allow bicycles with an axle distance of up to 130 cm to be transported.
- Satisfaction **of the highest quality and safety requirements.**
- **High load-carrying capacity** of 2 x 30 kg bicycle weight. Every bicycle (from racing bikes to E-bikes) can be transported.
- **Lightweight** yet **stable** and very durable.
- **Simple installation** (the wheels are secured using a ratchet system; single-handed operation of the ball head clamp system).
- Fold-down function for **better access** to the rear of the car.
- **Adjustable lights** cover vehicle widths (without mirrors) or bicycle lengths of up to 2000 mm (also suitable for F01 and F07 cars).
- **Includes** universal registration plate holder.

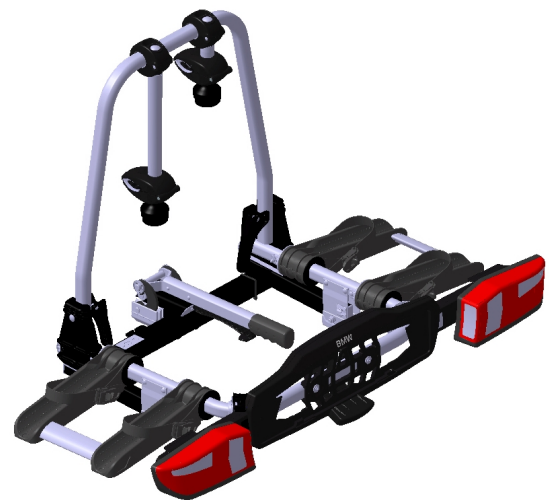

Rear bicycle carrier

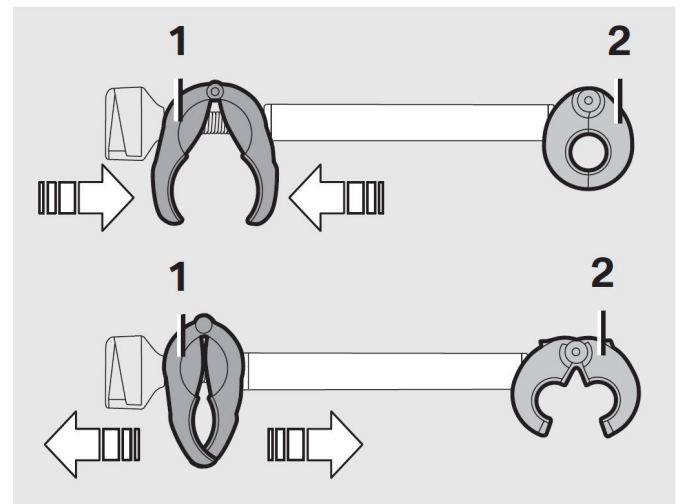

Diagram of removable retaining arms

Content / relevance

Please note that this product information is intended solely as prior information regarding new products.

Before ordering, always check the specified part numbers in the EPC. Only the EPC provides the information that should be taken as valid and current.

Complete price package

For a detailed tender preparation, find the complete price package on the KSD DVD.

Please refer to your price system or the latest price publications for the latest prices.

Development of the bicycle carrier for the trailer tow hitch (E-bike)

Suitable for all models



Exhaust heat shield

Cross-selling

The product package is especially ideal for cross-selling with:

- Extension for 3rd wheel rail.
- NEW: Black transport bag, extendible, also suitable for use with the 3rd wheel rail.
- Sectioned approach rail for easier loading, including suitable bag.
- BMW Lifestyle bicycles and E-bikes.
- Original BMW trailer tow hitches retrofit.

Technical information

- Dimensions (L x W x H) without the 3rd wheel rail fitted:
 - ° Folded: 640 x 640 x 243 mm
 - ° Open: 640 x 1190 x 745 mm
- Weight without the 3rd wheel rail: approx. 14 kg
- Wheel rail distance 220 mm
- Bicycle length (with central alignment) up to 1300 axle distance (front axle to rear axle on bicycle)



Note:

For cars with high-riding exhaust systems (such as the X5 and X6), exhaust heat shield bearing part number 82 72 2 344 298 must be installed on the left and right. ◀



Safety instructions:

Loosely-fitted bicycle components (e.g. battery pack, panniers, baskets, child seats, etc.) must be removed before setting off. Before fitting the carrier on the trailer tow hitch, the relevant cleaning materials must first be used to ensure that the ball and the clamp system are free from oil and grease. By fitting the 3rd wheel rail and the resulting longer lever arm, the overall weight-carrying capacity of the rear carrier reduces from 60 kg to 52 kg. ◀

Installation time

When fitted by the customer, around 5-10 minutes for the first time. Around 2 minutes are required for each subsequent fitting.

Installation information

Bicycle carrier for the trailer tow hitch and extension kit for a 3rd bicycle	01 29 2 287 889
Exhaust heat shield	01 29 2 287 882

Part numbers

Name	Availability / EPC DVD	Part number
Bicycle carrier for the trailer tow hitch	From 05/2014	82 72 2 287 886
Extension kit for 3rd bicycle	From 05/2014	82 72 2 287 888
Rear carrier approach rail	Since 05/2012	82 72 2 295 787
Transport bag	From 04/2014	82 72 2 289 653
Exhaust heat shield	From 04/2014	82 72 2 344 298